

FIG-1

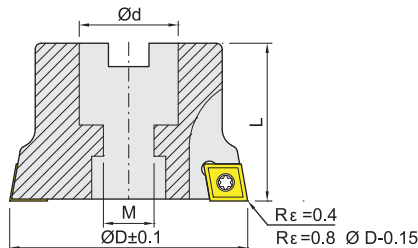

FIG-2

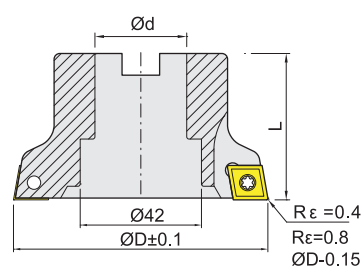



FIG-1 Item code (d=22.0)	FIG-1 Item code (d=25.4)	Insert 	FIG-1 Item code (d=22.0,25.4)	Insert 	D Rε=0.4	Teeth
TB45-22.0-CC09	TB50-25.4-CC09	CC..09T304			44.8	2
TB46-22.0-CC09					45.8	
TB47-22.0-CC09					46.8	
TB48-22.0-CC09					47.8	
TB49-22.0-CC09					48.8	
TB50-22.0-CC09					49.8	
TB51-22.0-CC09	TB51-25.4-CC09	CC..09T304	TB55-22.0-CC12	CC..120404	50.8	2
TB52-22.0-CC09	TB52-25.4-CC09				51.8	
TB53-22.0-CC09	TB53-25.4-CC09				52.8	
TB54-22.0-CC09	TB54-25.4-CC09				53.8	
TB55-22.0-CC09	TB55-25.4-CC09				54.8	
TB56-22.0-CC09	TB56-25.4-CC09	CC..09T304	TB56-22.0-CC12 TB57-22.0-CC12 TB58-22.0-CC12 TB59-22.0-CC12 TB60-22.0-CC12	CC..120404	55.8	2
TB57-22.0-CC09	TB57-25.4-CC09				56.8	
TB58-22.0-CC09	TB58-25.4-CC09				57.8	
TB59-22.0-CC09	TB59-25.4-CC09				58.8	
TB60-22.0-CC09	TB60-25.4-CC09				59.8	
TB61-22.0-CC09	TB61-25.4-CC09	CC..09T304	TB61-25.4-CC12 TB62-25.4-CC12 TB63-25.4-CC12 TB64-25.4-CC12 TB65-25.4-CC12	CC..120404	60.8	2
TB62-22.0-CC09	TB62-25.4-CC09				61.8	
TB63-22.0-CC09	TB63-25.4-CC09				62.8	
TB64-22.0-CC09	TB64-25.4-CC09				63.8	
TB65-22.0-CC09	TB65-25.4-CC09				64.8	
TB66-22.0-CC09	TB66-25.4-CC09	CC..09T304	TB66-25.4-CC12 TB67-25.4-CC12 TB68-25.4-CC12 TB69-25.4-CC12 TB70-25.4-CC12	CC..120404	65.8	2
TB67-22.0-CC09	TB67-25.4-CC09				66.8	
TB68-22.0-CC09	TB68-25.4-CC09				67.8	
TB69-22.0-CC09	TB69-25.4-CC09				68.8	
TB70-22.0-CC09	TB70-25.4-CC09				69.8	
TB71-22.0-CC09	TB71-25.4-CC09	CC..09T304	TB71-25.4-CC12 TB72-25.4-CC12 TB73-25.4-CC12 TB74-25.4-CC12 TB75-25.4-CC12	CC..120404	70.8	2
TB72-22.0-CC09	TB72-25.4-CC09				71.8	
	TB73-25.4-CC09				72.8	
	TB74-25.4-CC09				73.8	
TB75-22.0-CC09	TB75-25.4-CC09				74.8	
	TB76-25.4-CC09	CC..09T304	TB76-25.4-CC12 TB77-25.4-CC12 TB78-25.4-CC12 TB79-25.4-CC12 TB80-25.4-CC12	CC..120404	75.8	2
	TB77-25.4-CC09				76.8	
	TB78-25.4-CC09				77.8	
	TB79-25.4-CC09				78.8	
	TB80-25.4-CC09				79.8	

固定式粗搪刀 FIXED ROUGH BORING BARS



FIG-1 Item code (d=25.4)	Insert 	FIG-1 Item code (d=25.4)	FIG-1 Item code (d=31.75)	FIG-2 Item code (d=31.75)	Insert 	D Rε=0.4	Teeth
TB81-25.4-CC09	CC..09T304	TB81-25.4-CC12			CC..120404	80.8	2
TB82-25.4-CC09		TB82-25.4-CC12				81.8	
TB83-25.4-CC09		TB83-25.4-CC12				82.8	
TB84-25.4-CC09		TB84-25.4-CC12				83.8	
TB85-25.4-CC09		TB85-25.4-CC12				84.8	
TB86-25.4-CC09	CC..09T304	TB86-25.4-CC12			CC..120404	85.8	2
TB87-25.4-CC09		TB87-25.4-CC12				86.8	
TB88-25.4-CC09		TB88-25.4-CC12				87.8	
TB89-25.4-CC09		TB89-25.4-CC12				88.8	
TB90-25.4-CC09		TB90-25.4-CC12				89.8	
TB91-25.4-CC09	CC..09T304	TB91-25.4-CC12			CC..120404	90.8	2
TB92-25.4-CC09		TB92-25.4-CC12				91.8	
TB93-25.4-CC09		TB93-25.4-CC12				92.8	
TB94-25.4-CC09		TB94-25.4-CC12				93.8	
TB95-25.4-CC09		TB95-25.4-CC12				94.8	
TB96-25.4-CC09	CC..09T304	TB96-25.4-CC12			CC..120404	95.8	2
		TB97-25.4-CC12				96.8	
TB98-25.4-CC09		TB98-25.4-CC12				97.8	
		TB99-25.4-CC12				98.8	
TB100-25.4-CC09		TB100-25.4-CC12	TB100-31.75-CC12	TB100-31.75-CC12F		99.8	
	CC..09T304	TB101-25.4-CC12	TB101-31.75-CC12		CC..120404	100.8	2
		TB102-25.4-CC12	TB102-31.75-CC12			101.8	
			TB103-31.75-CC12			102.8	
			TB104-31.75-CC12			103.8	
TB105-25.4-CC09		TB105-25.4-CC12	TB105-31.75-CC12	TB105-31.75-CC12F		104.8	
	CC..09T304		TB106-31.75-CC12		CC..120404	105.8	2
			TB107-31.75-CC12			106.8	
TB108-25.4-CC09		TB108-25.4-CC12	TB108-31.75-CC12			107.8	
			TB109-31.75-CC12			108.8	
TB110-25.4-CC09		TB110-25.4-CC12	TB110-31.75-CC12	TB110-31.75-CC12F		109.8	
	CC..09T304		TB111-31.75-CC12		CC..120404	110.8	2
TB112-25.4-CC09		TB112-25.4-CC12	TB112-31.75-CC12			111.8	
			TB113-31.75-CC12			112.8	
			TB114-31.75-CC12			113.8	
TB115-25.4-CC09		TB115-25.4-CC12	TB115-31.75-CC12	TB115-31.75-CC12F		114.8	
	CC..09T304		TB116-31.75-CC12		CC..120404	115.8	2
			TB117-31.75-CC12			116.8	
		TB118-25.4-CC12	TB118-31.75-CC12			117.8	
			TB119-31.75-CC12			118.8	
TB120-25.4-CC09		TB120-25.4-CC12	TB120-31.75-CC12	TB120-31.75-CC12F		119.8	
	CC..09T304		TB121-31.75-CC12		CC..120404	120.8	2
TB122-25.4-CC09			TB122-31.75-CC12			121.8	
			TB123-31.75-CC12			122.8	
			TB124-31.75-CC12			123.8	
			TB125-31.75-CC12			124.8	
			TB126-31.75-CC12		CC..120404	125.8	2
			TB127-31.75-CC12			126.8	
			TB128-31.75-CC12			127.8	
			TB129-31.75-CC12			128.8	
			TB130-31.75-CC12			129.8	

Insert	Screw	Wrench
CC..060204	MS2506A	ETF09
CC..09T304	MS4011A	ETF15
CC..120404	MS5011A	ETF20

Dimensions,mm	d	M	L
TB...-22.0-...	22.0	11	50
TB...-25.4-...	25.4	13	50
TB...-31.75-...	31.75	13	50

內徑車刀
BORING BARS

外徑車刀
TOOL HOLDERS

牙刀 & 開槽刀
THREADING & GROOVING

銑刀
MILLING

孔加工
BORING TOOLS COMPONENTS

配件
SPARE PARTS

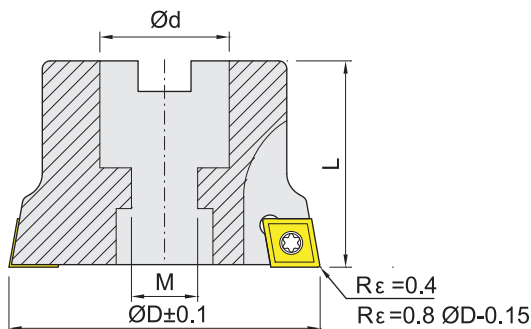
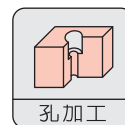

内徑車刀
BORING BARS
外徑車刀
TOOL HOLDERS
牙刀 & 開槽刀
THREADING & GROOVING
銑刀
MILLING
孔加工
BORING TOOLS COMPONENTS
配件
SPARE PARTS

Item code (d=31.75)	Item code	Item code	Insert 	D Rε=0.4	Teeth
TB131-31.75-CC12			CC..120404	130.8	2
TB132-31.75-CC12				131.8	
TB133-31.75-CC12				132.8	
TB134-31.75-CC12				133.8	
TB135-31.75-CC12				134.8	
TB136-31.75-CC12			CC..120404	135.8	2
TB137-31.75-CC12				136.8	
TB138-31.75-CC12				137.8	
TB139-31.75-CC12				138.8	
TB140-31.75-CC12				139.8	
TB141-31.75-CC12			CC..120404	140.8	2
TB142-31.75-CC12				141.8	
TB143-31.75-CC12				142.8	
TB144-31.75-CC12				143.8	
TB145-31.75-CC12				144.8	
TB146-31.75-CC12			CC..120404	145.8	2
TB147-31.75-CC12				146.8	
TB148-31.75-CC12				147.8	
TB149-31.75-CC12				148.8	
TB150-31.75-CC12				149.8	
TB151-31.75-CC12			CC..120404	150.8	2
TB155-31.75-CC12				154.8	
TB156-31.75-CC12				155.8	
TB160-31.75-CC12				159.8	
TB161-31.75-CC12				160.8	
TB165-31.75-CC12			CC..120404	164.8	2
TB170-31.75-CC12				169.8	
TB175-31.75-CC12				174.8	
TB185-31.75-CC12				184.8	
TB187-31.75-CC12				186.8	
TB190-31.75-CC12			CC..120404	189.8	2
TB195-31.75-CC12				194.8	
TB200-31.75-CC12				199.8	
TB201-31.75-CC12				200.8	

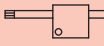
Insert	Screw 	Wrench 
CC..060204	MS2506A	ETF09
CC..09T304	MS4011A	ETF15
CC..120404	MS5011A	ETF20

Dimensions,mm	d	M	L
TB...-22.0-...	22.0	11	50
TB...-25.4-...	25.4	13	50
TB...-31.75-...	31.75	13	50